

PLANNED USE OF VACATED GOVERNMENT PRINTING OFFICE SPACE

10-15-84

BUILDING 720B LAYOUT

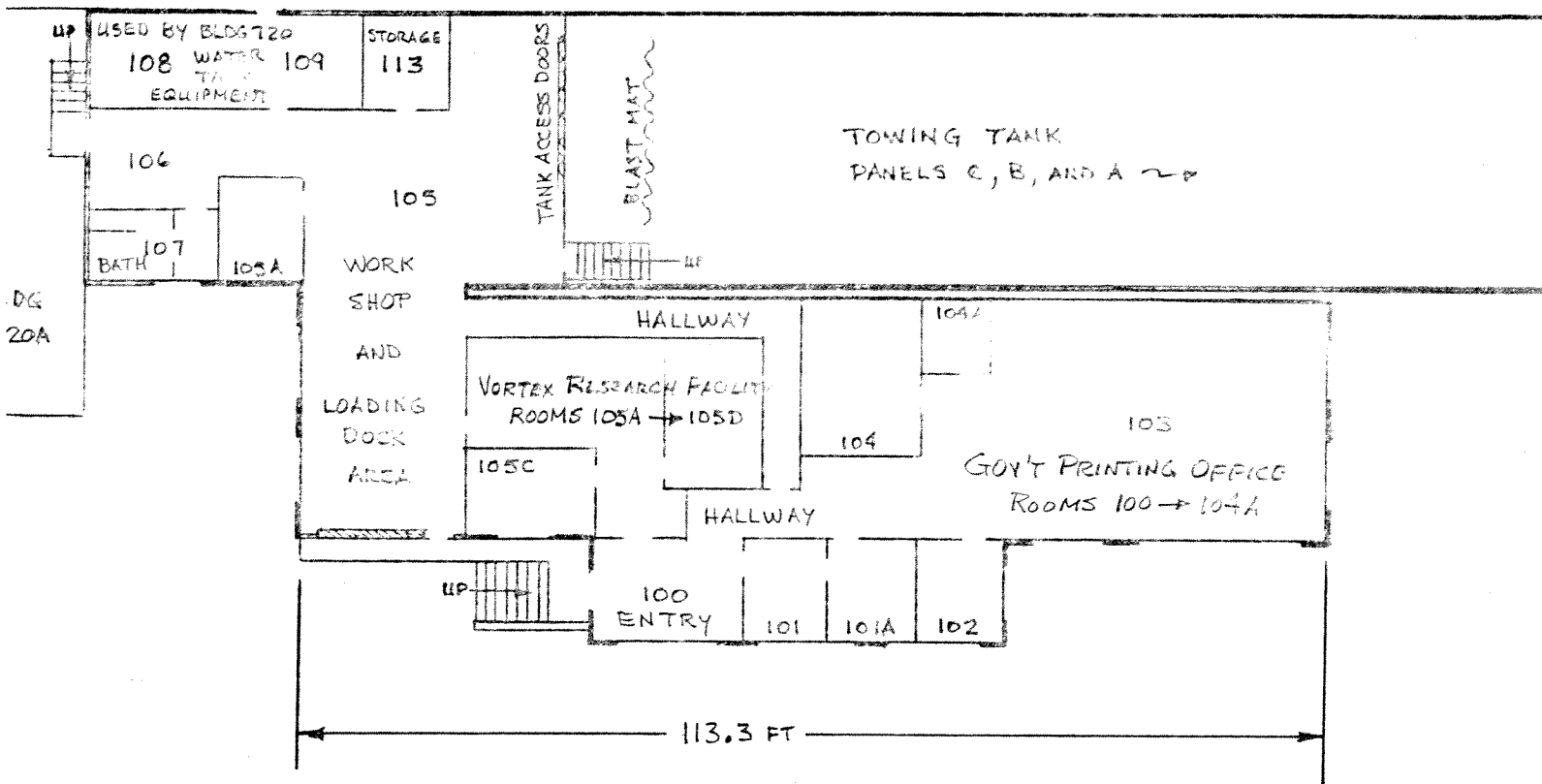

- GOVERNMENT PRINTING OFFICE TO RELOCATE OFF LAFB ON NOV. 1, 1984.
- ANALYTICAL METHODS BRANCH - VORTEX RESEARCH FACILITY IS PRESENTLY STAFFED WITH 7 PERSONNEL IN AN AREA OF 390 SQ. FT. OFFICE SPACE + 400 SQ. FT. LAB AND STORAGE SPACE
- AMB/LSAD ACQUIRING NEW WIND TUNNEL FACILITY IN NOV., 1984 TO BE HOUSED IN ADJACENT BUILDING 720A. ADDED RESEARCH CAPABILITIES WILL REQUIRE ADDITIONAL SPACE FOR:
 - 3 TO 5 MORE PERSONNEL
 - HOT WIRE CALIBRATION LAB
 - COMPUTER WORK AREA
 - CONFERENCE ROOM
 - ENLARGED ELECTRONICS LAB
 - EXTRA STORAGE

BUILDING 720B AS OF OCTOBER 1984

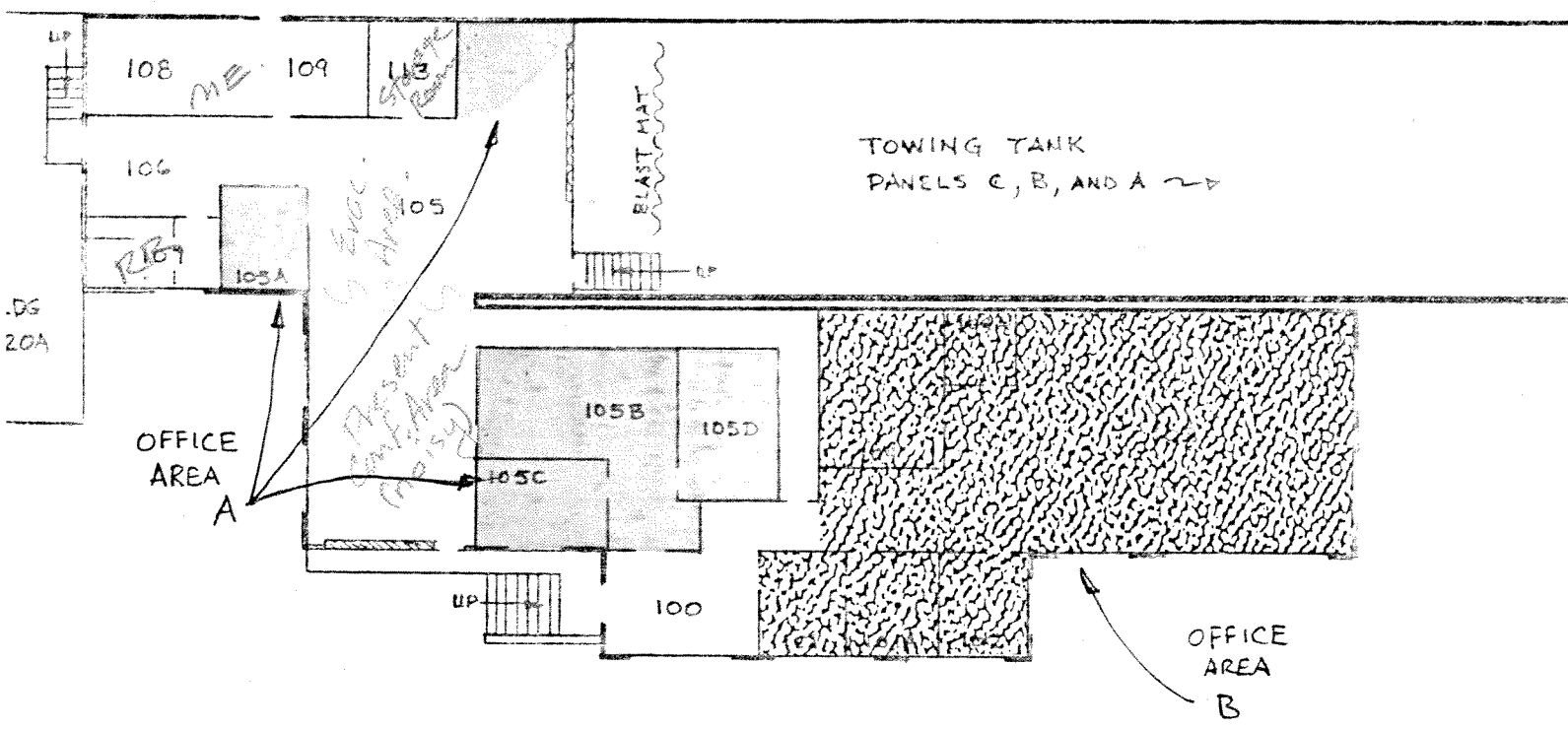

• OFFICE AREA A: ~780 ft² → 380 ft² OFFICE SPACE + 400 ft² LAB, STORAGE, EQUIPMENT

- OCCUPANTS:
- RAY SCHOLZ - 105A
 - DAVE THOMPSON - 105 (REAR)
 - GEORGE GREENE - 105C
 - DAN NEUHART - 105C
 - DALE SATRAN - 105D
 - TOM HOLBROOK - 105D
 - JIM CHAMBERLAIN - 105B

- COMPUTER/DATA ACQUISITION LAB AND STORAGE IN RM 105B
- ELECTRONICS REPAIR, TECHNICIAN WORK AREA, AND STORAGE IN RM 105 (REAR)

Sanford

Kevin Myle
Engineer

4 hrs/day avg.

• OFFICE AREA B: ~1840 ft²

PRESENTLY OCCUPIED BY THE GOVERNMENT PRINTING OFFICE

PROPOSED USE OF BUILDING 720B AS OF DECEMBER 1984

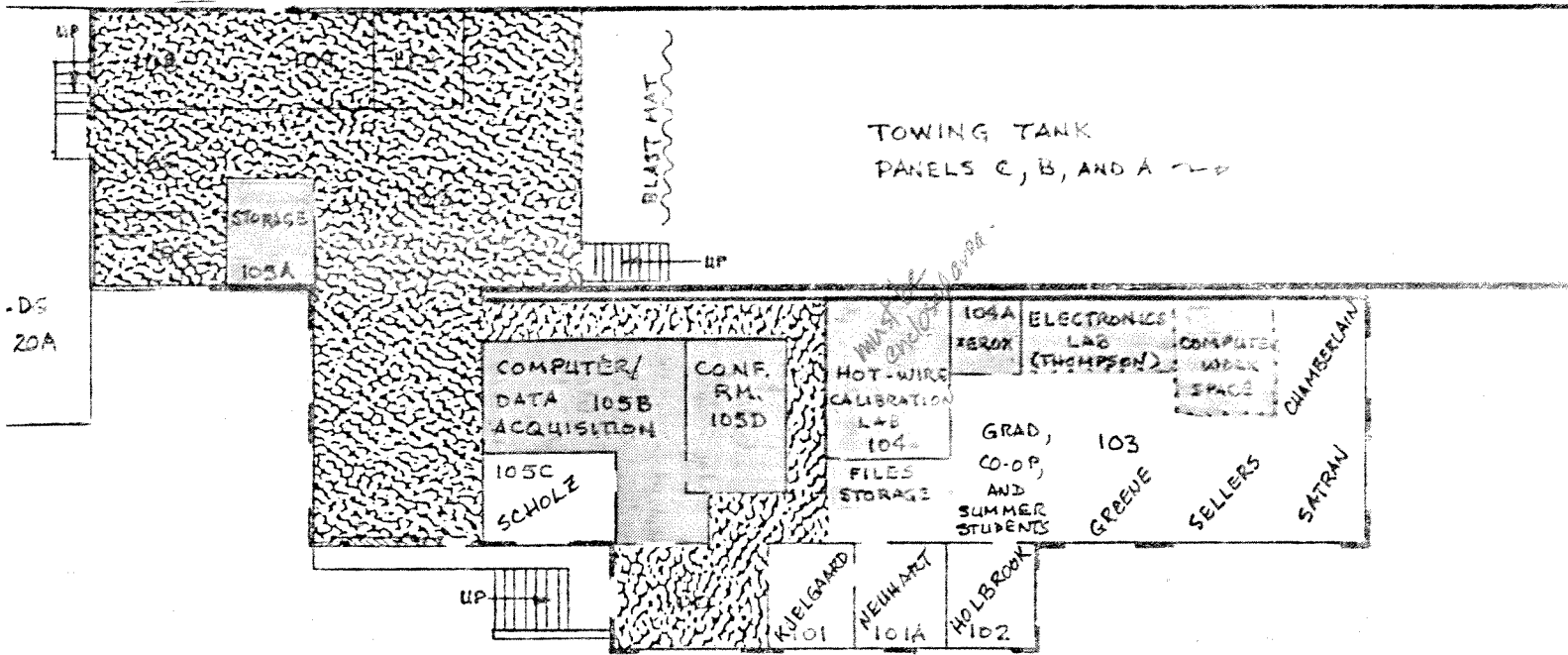

- LAB, CONFERENCE, AND STORAGE AREAS ~ 1250 ft² :
 - RM105A - STORAGE
 - RM105B - COMPUTER AND DATA ACQUISITION SYSTEM
 - RM105D - CONFERENCE ROOM
 - RM104 - HOT-WIRE CALIBRATION LAB
 - RM104A - XEROX AND STOCK SUPPLIES
 - RM103 - ELECTRONICS LAB
 - COMPUTER TERMINAL WORK SPACE
 - FILES STORAGE FOR VRF

GPO out Nov 1. to Oyster Point

- OFFICE AREAS ~ 1310 ft²
 - RM105C - RAY SCHOLZ
 - RM101 - SCOTT KJELGAARD *NASAs 20th new tunnel*
 - RM101A - DAN NEUHART
 - RM102 - TOM HOLBROOK
 - RM103 - DALE SATRAN,
 - JIM CHAMBERLAIN, *NASAs 20th new tunnel*
 - CO-OP STUDENT
 - BILL SELLERS, *NASAs 20th new tunnel*
 - SUMMER STUDENT
 - GEORGE GREENE *Kentron*
 - DAVE THOMPSON

17 on board

- ROOM 105 (REAR) CONVERTED TO OPEN SPACE FOR CLEARANCE DURING RUNS ~ 60 ft²